



QUICK FACTS

Level: Intermediate
Need to have both woodturning and wood working skill.

Time: above 2 hours

YOU'LL NEED

Please refer to the drawing in appendix

SAFETY

Always read & understand the instruction manual for any product or equipment before using.

Always use safe practices & appropriate safety equipment.

Only use genuine Teknatool/NOVA parts and products.

After I had tidied up my tiny hobby-cellar-workshop to free enough space for establishing my brand new TEKNATOOL DVR-XP lathe, there was left a remarkable pile of scrap wood in front of my hobby den. But for turning all these wood pieces into bottle stopper, light pulls, tool handles and things like that, I surely could have kept my small old lathe. So I was pondering for a demanding project, to be assembled from small parts which most of them – if not all – could be produced on my Teknatool lathe.

Suddenly I had a wooden tractor in my mind. Of course, it was clear to me, I need to develop my idea in detail on sketch paper before switching on the lathe. I was really keen to get started with turning. Although, I worked out many details to the design affectionately, I didn't care much about the use of my tractor. Now, some feel it's to lavish for a toy, other may think it's not naturalistic enough for a model, but fortunately, almost everybody agrees: Its, a great eye - catcher!

With the finished sketch in my left hand I was ransacking my scrap wood stack to find the best fitting pieces in both: dimension and color/texture for each part on the sketch. Some work on the band saw, some holes to be drilled, gluing the motor block together – turning can start!

As always with a new thing, first, we need us to familiarize with it. Therefore, I promised to myself, immediately to interrupt turning, if I feel, some feature on my lathe is missing or unwieldy and applying appropriate changes first! Let's have a look at the photos for some examples:

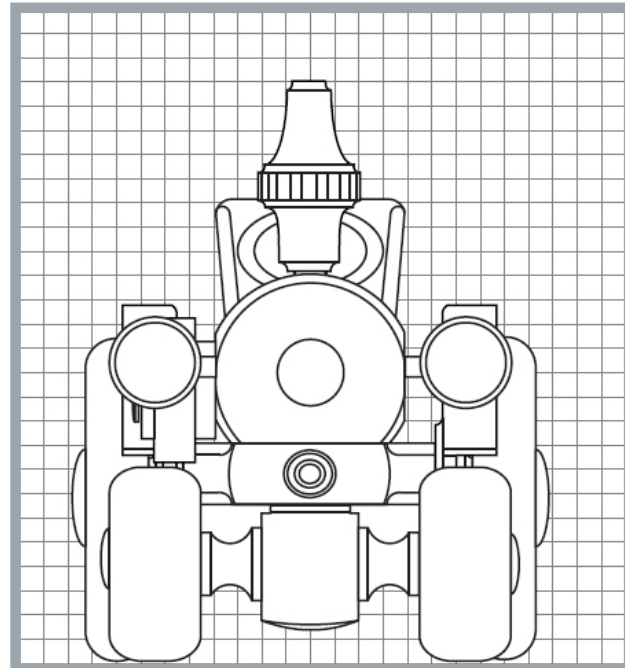
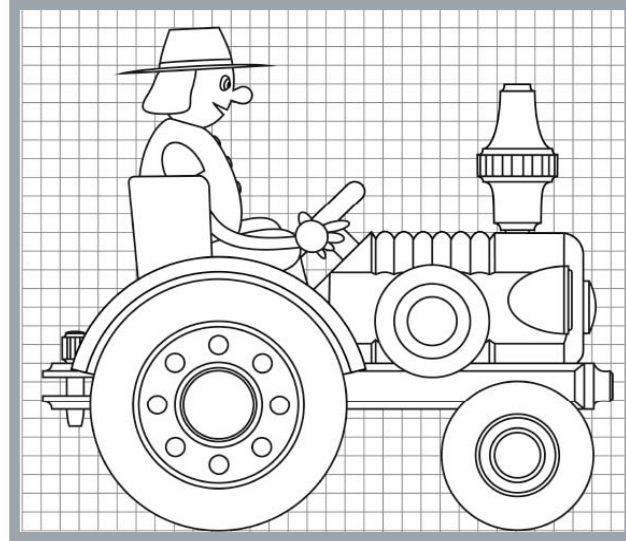



NOVA PROJECT MAKING A TOY TRACTOR

First of all I ordered some additional Jaws for the NOVA Chuck, which I got as a bonus, when I bought my lathe. Fig. 1 shows the base of the tractor, held by two segment of the long nose jaw.



Fig. 2: With this strong grip, decorating this wobbling board is not as dangerous as it seems to be.



Fig. 3: This shop made sanding disk (only the Velcro pad and the flange where bought parts) is a great helper for some finishing-tasks, like trimming the ready turned motor block.



Fig. 4: I turned a centering-recess on the small faceplate, which came with my DVR XP lathe. And I attached it to a small chuck from a metalworker's lathe, which makes chucking small parts much easier for me.



Fig. 5: I became inspired for experimenting with an old cross slide from a scrap yard, when I saw Teknatool's web pages about the Ornamental turner. Unfortunately is this versatile device not on the European market.

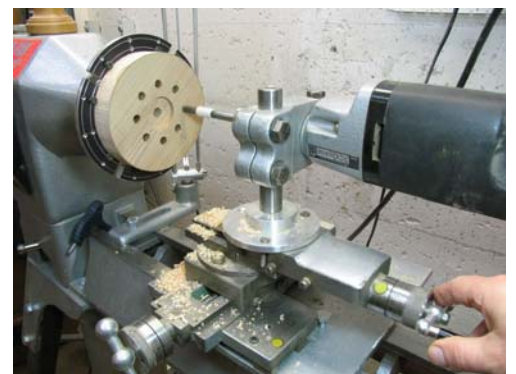



NOVA PROJECT MAKING A TOY TRACTOR



Fig. 6 u. 7: Of course, my breadboard construction can't provide all the features of the Ornamental-turner, but decent and appropriate decoration could surely enhance some parts of my tractor in a funny way.

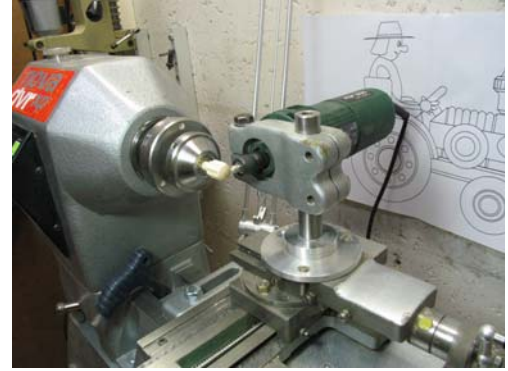
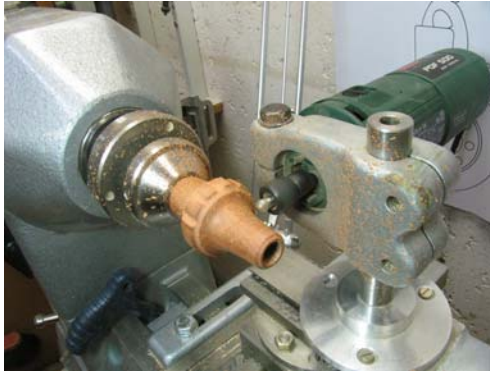

Fig. 8: The swivel-headstock was brought to a convenient position, before hollowing the shape for the driver's seat. – A great advantage especially in such a small workshop as mine.

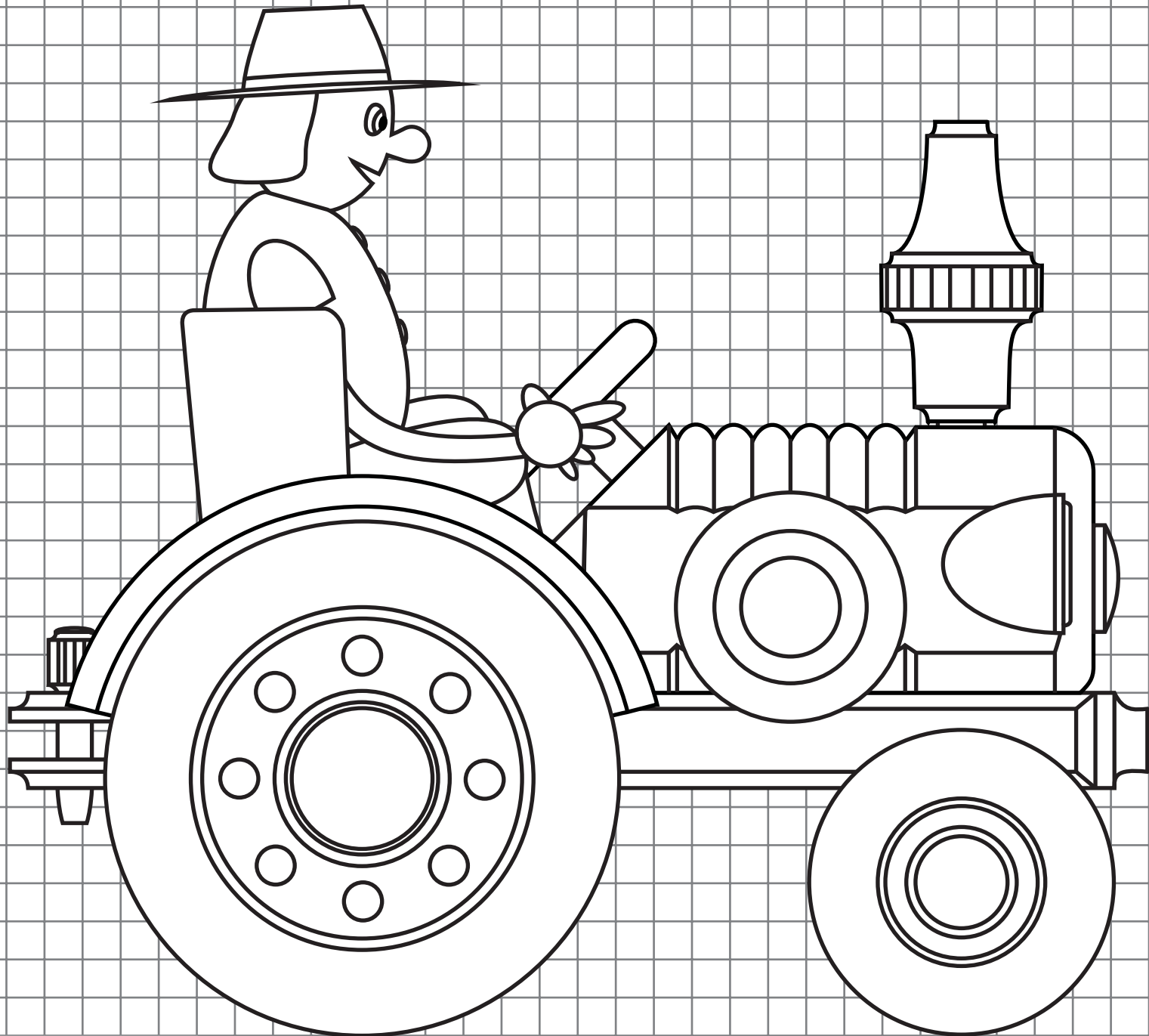

Fig. 9: There are a lot of small wood parts had to be polished. Therefore I mounted all three mobs of my wood polishing system on a threaded steel rod, to make this procedure faster.



After assemble all parts together, the toy tractor is finally completed!





PROJECT Toy Tractor

Courtesy of the German
Woodworking Magazine

HolzWerken
www.holzwerken.net

Autor: Hans-Günter König
©Vincentz Network

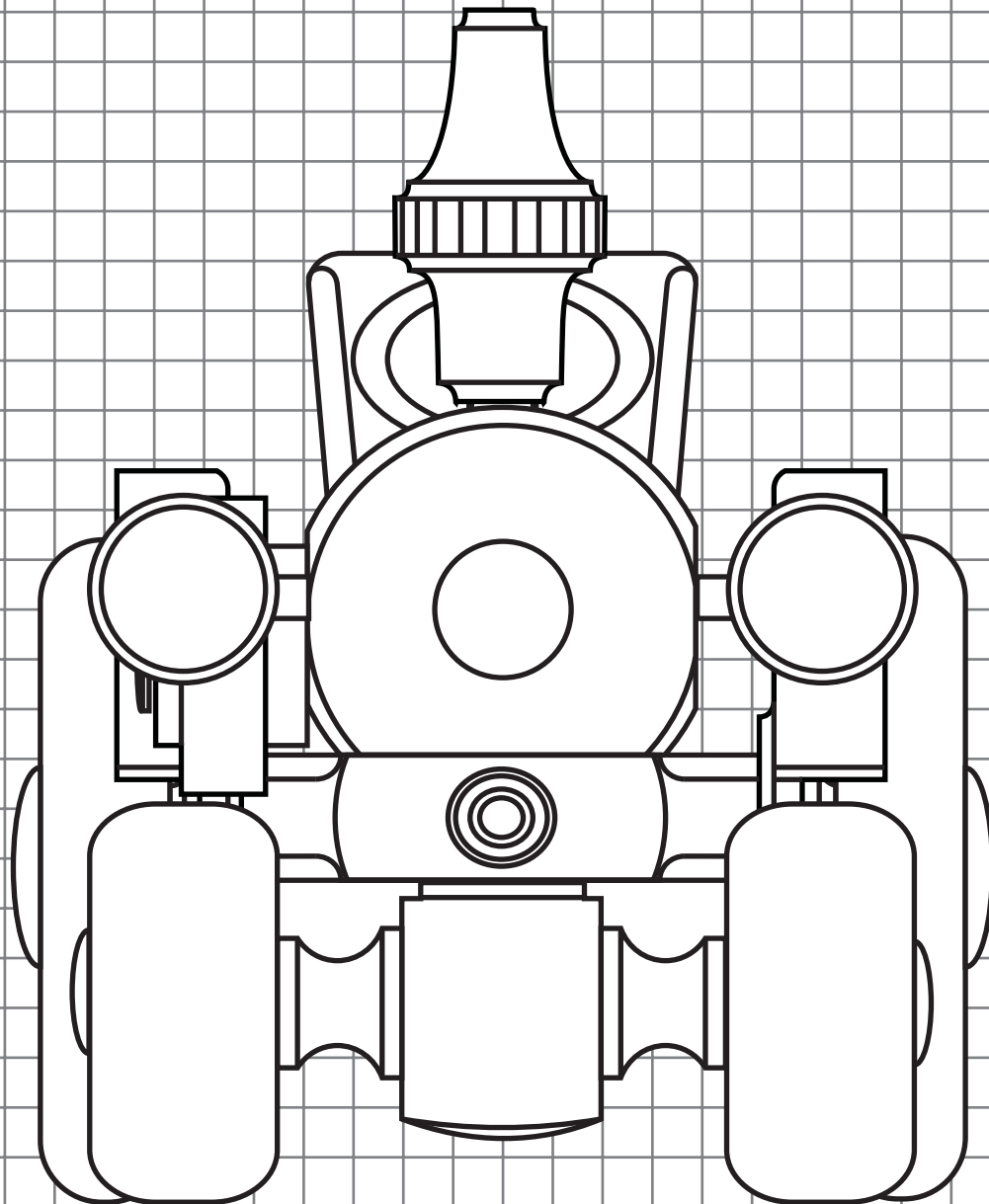

Specification

Part.	Name	Quantity
1	Base	1
2	Engine	1
3	Mudguard	2
4	Steering Bar	1
5	Exhaust Valve	1
6	Brake (Rear)	2
7	Brake (Front)	2
8	Axis (Rear)	2
9	Axis (Front)	2
10	Flywheel	1
11	Washer for Flywheel	1
12	Bolt for Flywheel	1
13	Gearbox	1
14	Driver's Seat	1
15	Steering wheel	1
16	Spacer for Steering wheel	1
17	Bolt for Steering wheel	1
18	Floodlight	2
19	Floodlight Holder	2
20	Bolt for Hitch	1
21	Front Wheel	2
22	Rear Wheel	2
23	Dowel 10mm	3
24	Wood screw ca. 3x25mm	4

On a Scale of: 1 : 1,5

(1 square means 1cm x 1 cm)

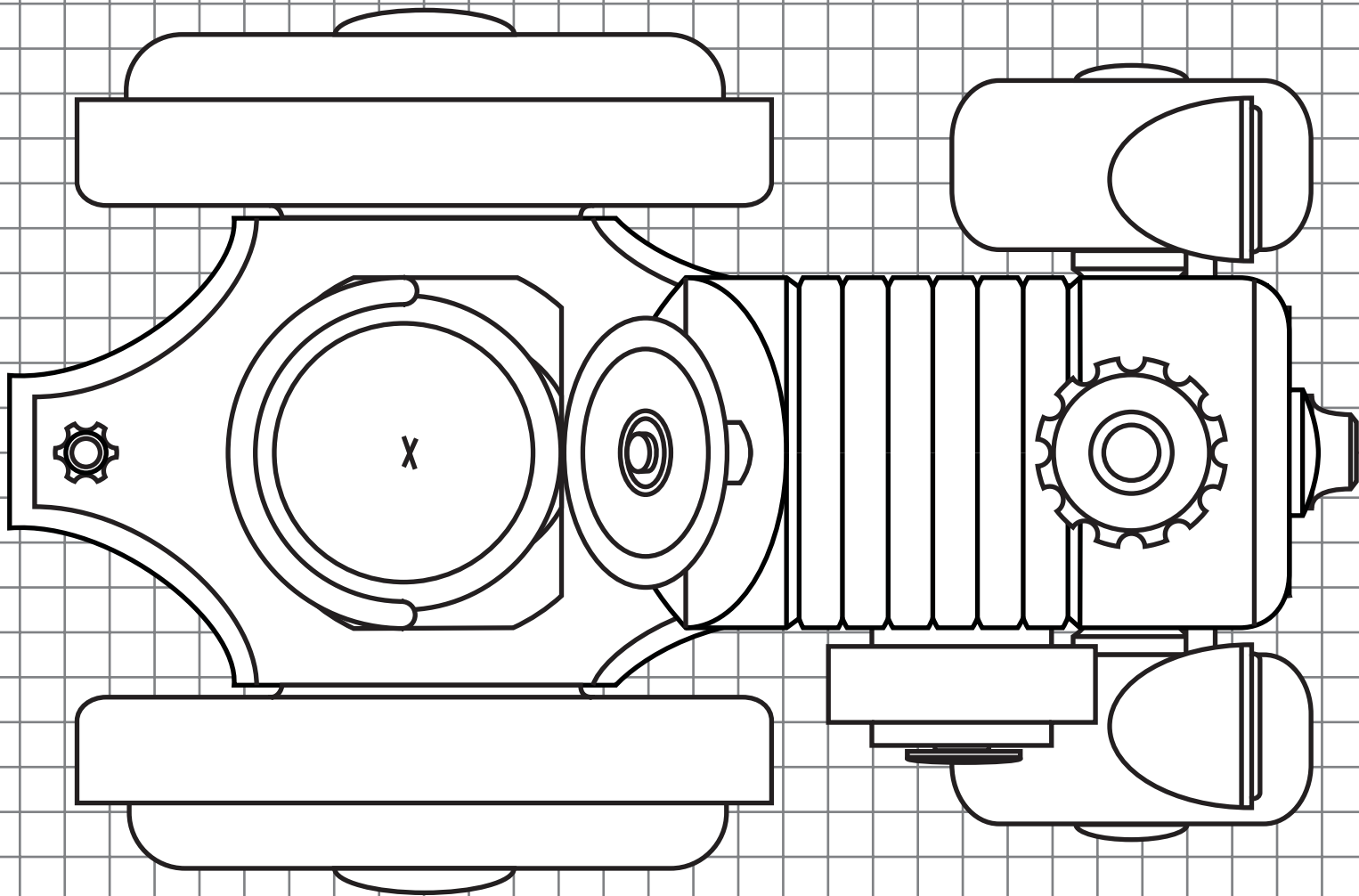

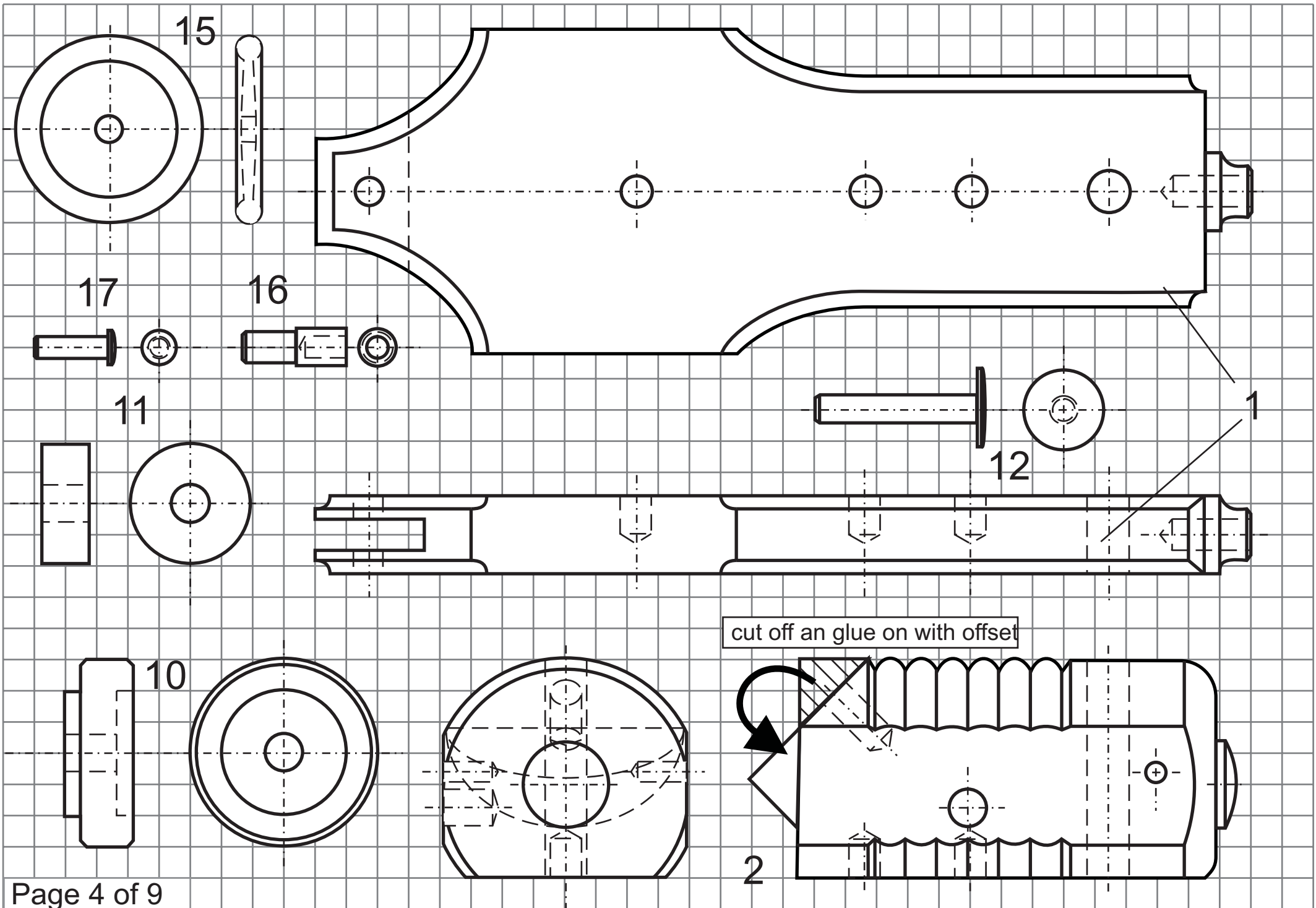

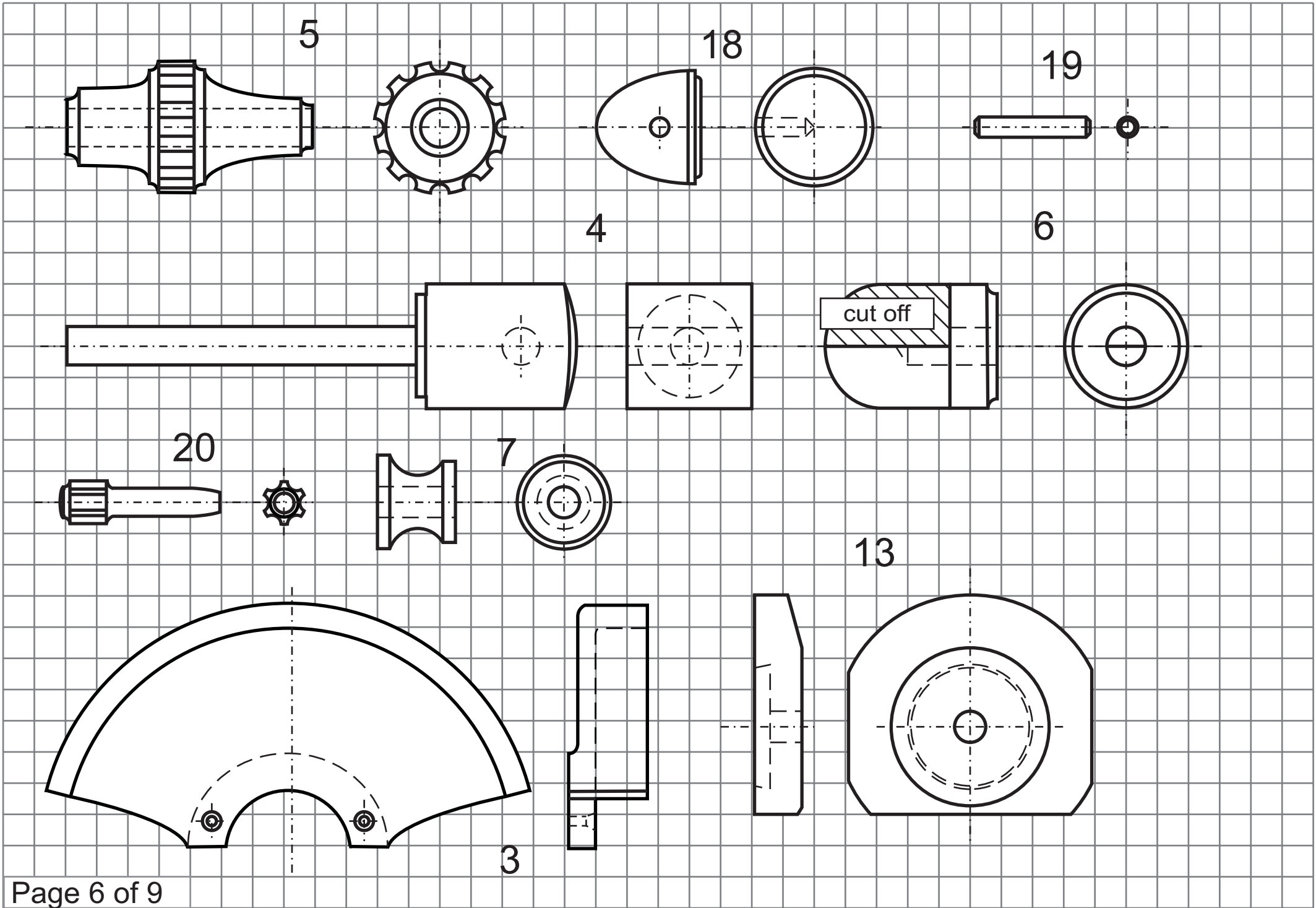

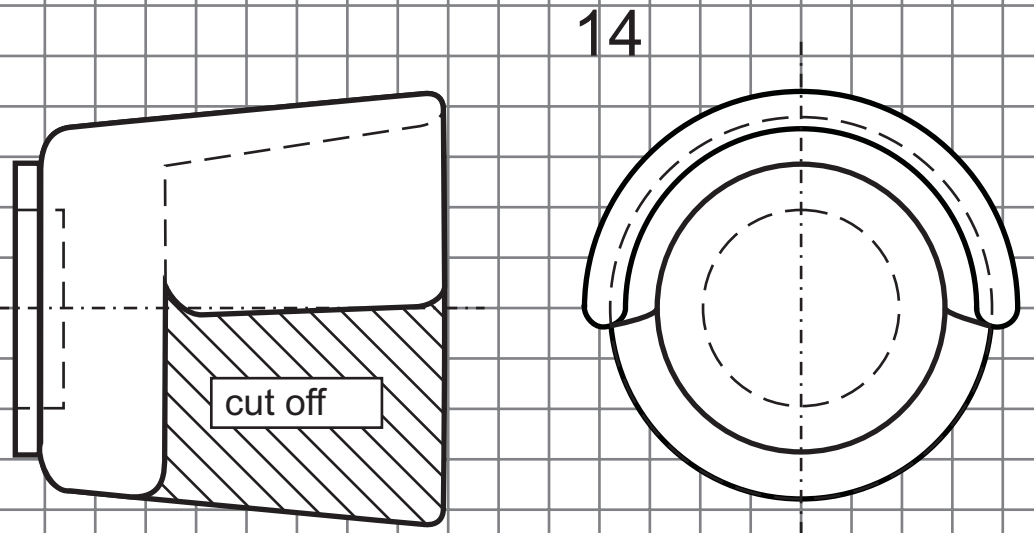
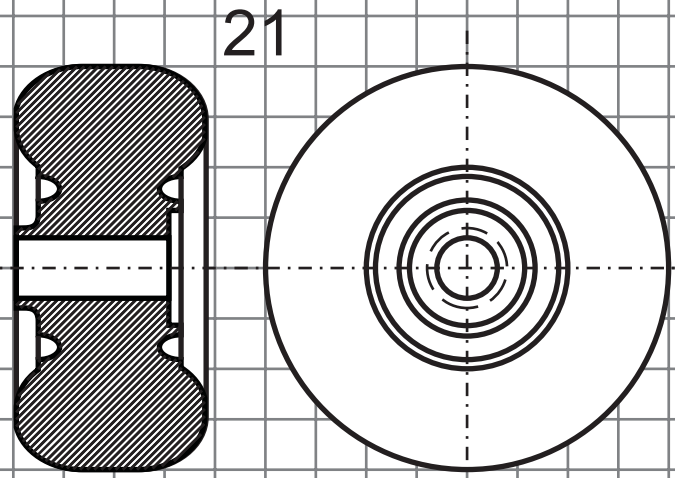
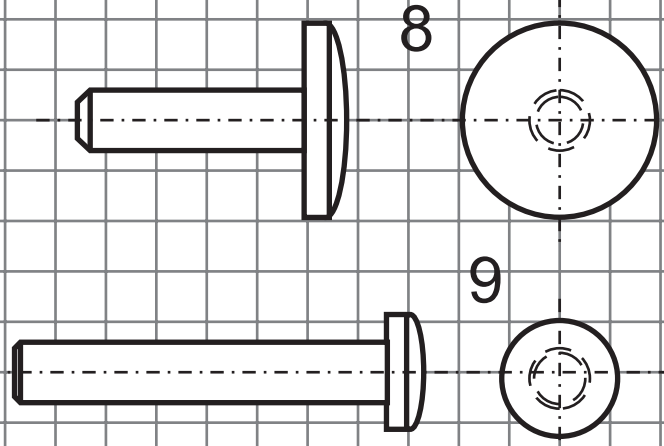
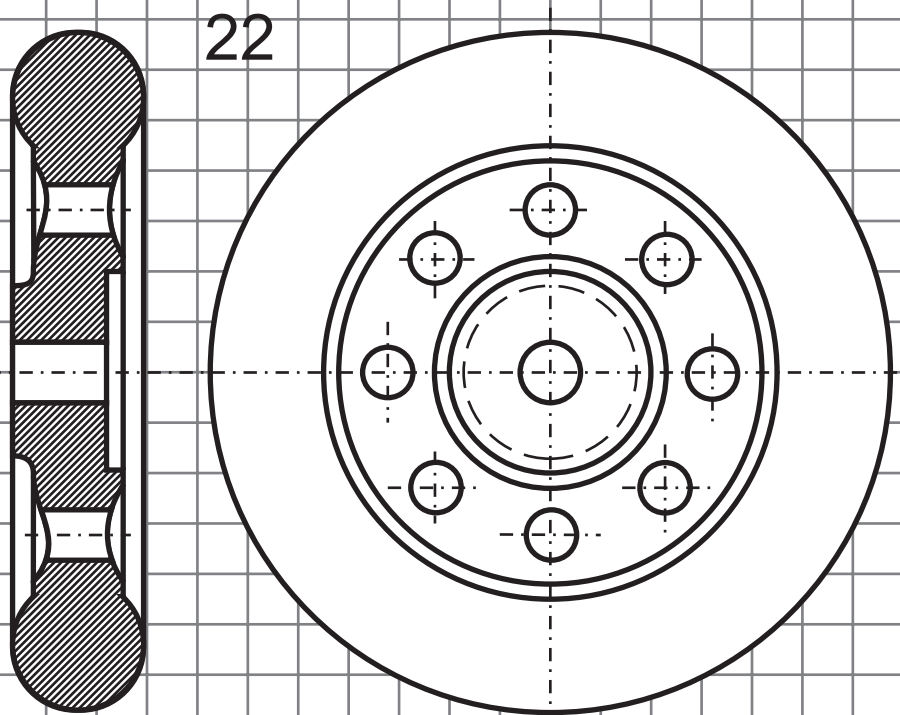

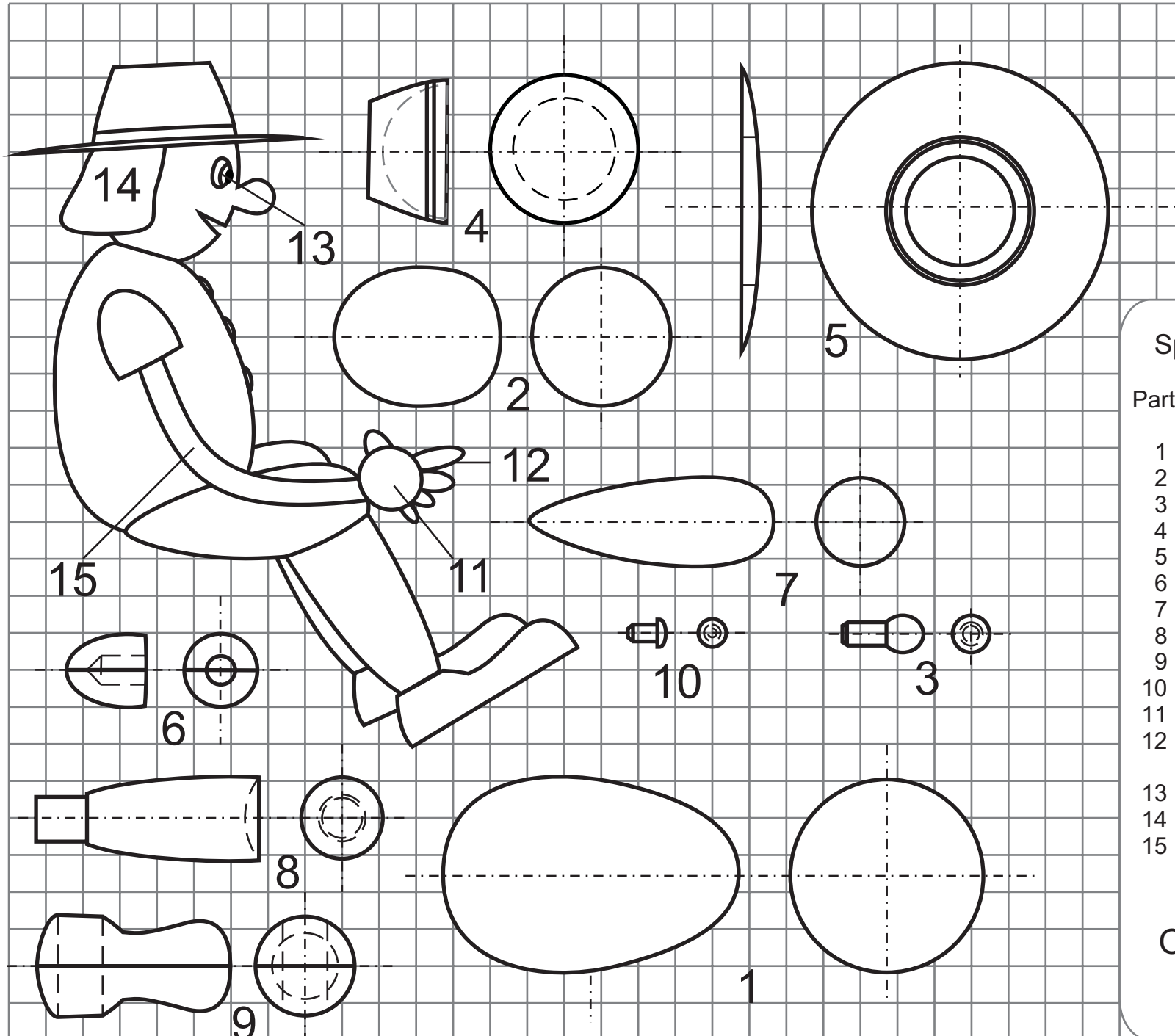

Specification for the Driver

Part	Name	Quantity
1	Body	1
2	Head	1
3	Nose	1
4	Hat	1
5	Brim	1
6	Sleeve	2
7	Thigh	2
8	Shank	2
9	Shoe	2
10	Button	3
11	Palm	2
12	Finger	10
13	Glass Eye	2
14	Fur, resampling Hair	1
15	Cord for Arms	2

On a Scale of: 1 : 1,5
 (1square means 1cm x 1 cm)

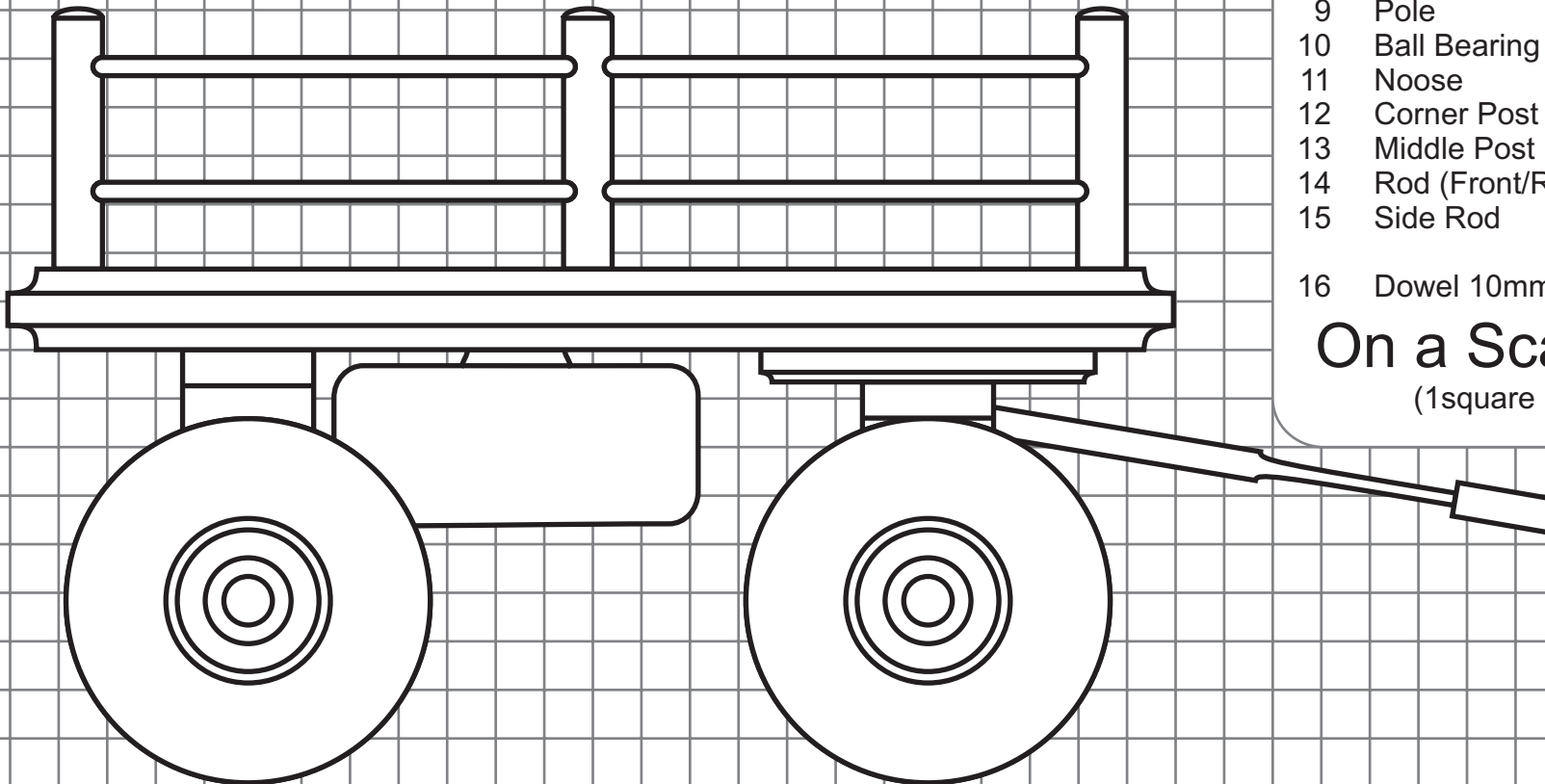

Specification for the Cart

Part	Name	Quantity
1	Cargo area	1
2	Wheel	5
3	Axis	4
4	Bolt	5
5	Undercarriage (Rear)	1
6	Undercarriage (Front)	1
7	Washer for Undercarriage (Front)	1
8	Pivot for Undercarriage (Front)	1
9	Pole	2
10	Ball Bearing	2
11	Noose	1
12	Corner Post	4
13	Middle Post	2
14	Rod (Front/Rear)	4
15	Side Rod	8
16	Dowel 10mm 2	

On a Scale of: 1 : 1,5

(1square means 1cm x 1 cm)

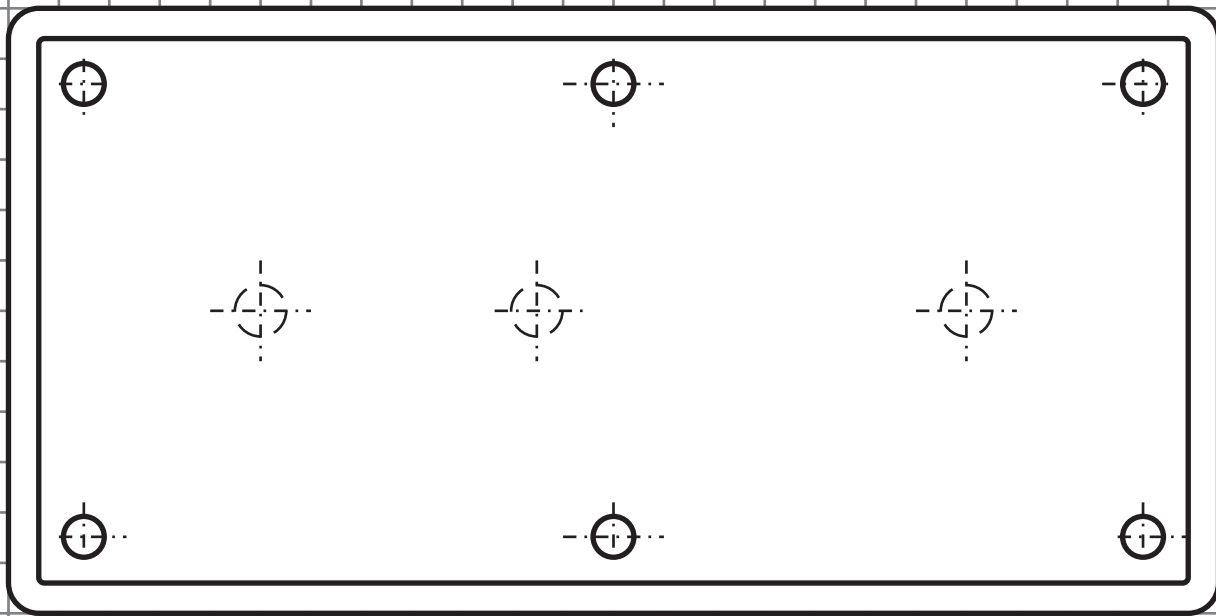

1

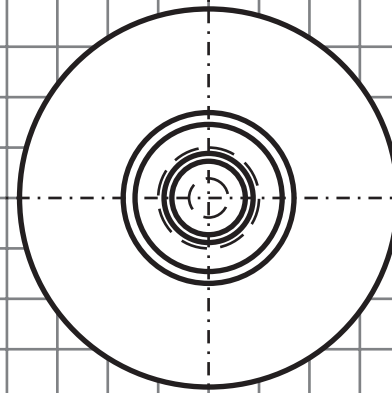

2

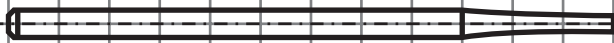
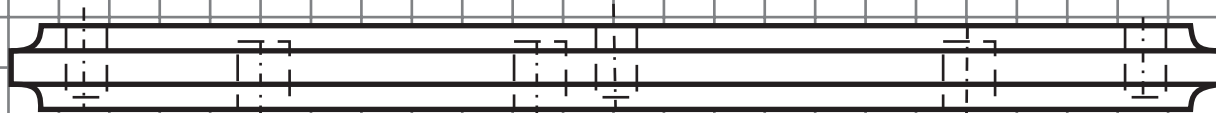
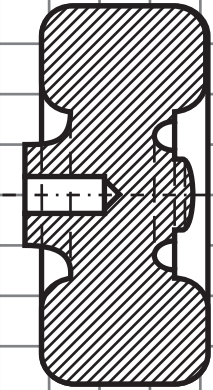

9



14



15

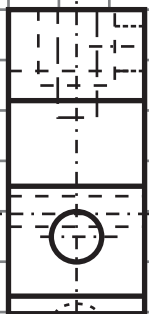

6

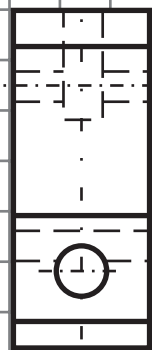
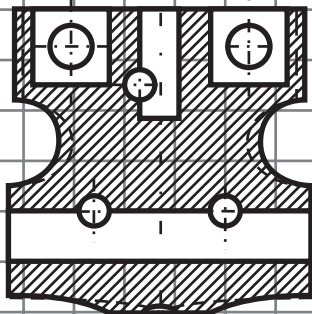

5

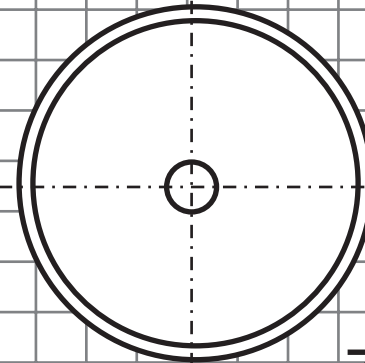
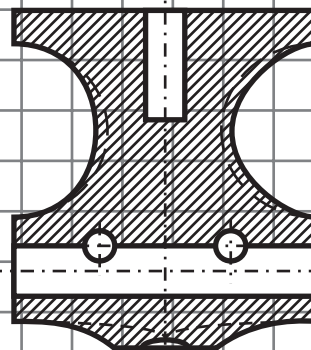

7

11



12



13



4



10

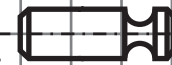

8

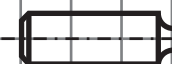

3